



1 区和 2 区

Zone 1 and Zone 2

21 区和 22 区

Zone 21 and zone 22

IIC、IIB级 防爆灯具篇

IIC、IIB Explosion-proof light fittings



CZ6365 防爆（应急）LED管形灯

CZ0264/30 防爆 LED 条形灯

CZ1865、CZ1866 全塑防爆 LED（应急）条形灯

CZ1363/3、CZ1363/4 防爆 LED（应急）条形灯

CZ1361、CZ1362 防爆（应急）LED 条形灯

CZ6474/1□□□ LED 防爆灯（平面灯、支架灯、嵌入式灯、墙壁式灯）

CZ6474-135、CZ6474-145 LED 防爆灯

CZ6474-235、CZ6474-245 LED 防爆灯

CZ0870d/LED 防爆灯

CZ6470/111 LED 防爆灯

CZ0878/211 防爆LED泛光灯（宽光型、窄光型、路灯型、标准型）

CZ0878/221 防爆LED泛光灯（宽光型、窄光型、路灯型）

CZ6478/121B 隔爆型防爆LED泛光灯（宽光型、窄光型、路灯型）

CZ0871、CZ0872 防爆灯

CZ0873/2□、CZ0874/2□ 防爆灯

CZ0878d 防爆泛光灯

CZ GSD 防爆高杆灯

MGSD 高杆灯

CZ6365

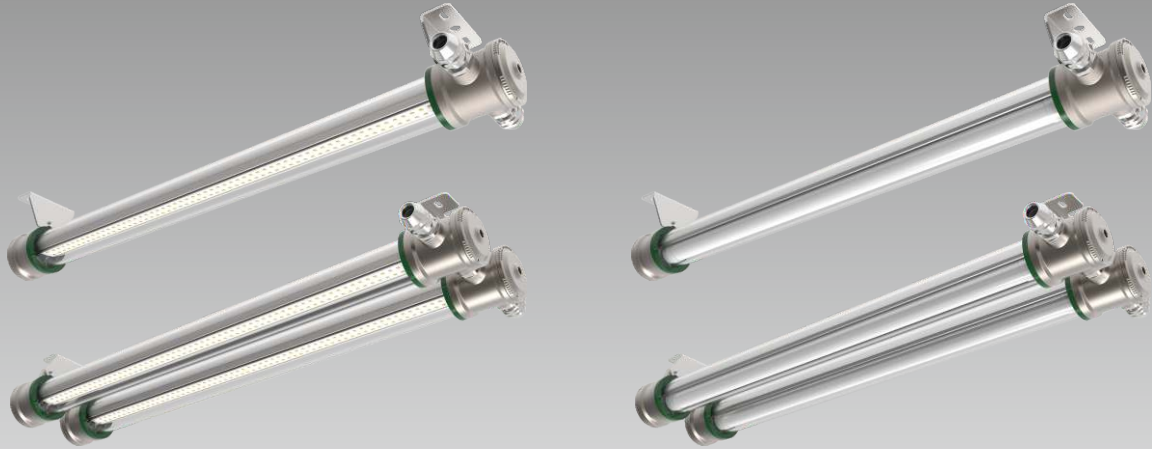
A

描述 Descriptions

防爆（应急）LED 管形灯壳体由 316L 不锈钢精密铸造工艺成型，透明灯罩采用高强度抗紫外线的 PC 制成，既适用于爆炸性环境，也适用于强腐蚀性的石化、化学场所和海洋环境等。

防爆（应急）LED 管形灯采用模块化设计，内置LED 光源模块或 LED 应急光源模块，非应急防爆 LED 管型灯可选配 T8 LED 灯管，打开灯盖，抽出光源模块即可更换光源和电器元件，方便维护和更换。

防爆（应急）LED管形灯分为平面式安装和夹管式安装两种。

- 长寿命免维护，使用寿命长达50000小时，可实现长期免维护
- 具有良好的电磁兼容性，不会对系统电网造成干扰
- 电压波动无影响，宽电压设计
- LED属于固态光源，抗震性能佳
- 安装维护方便
- 防护等级高达IP66 / IP67
- IECEx、ATEX认证
- 光效≥135lm/W（符合中国一级能效标准）

The explosion-proof (emergency) LED tubular light fittings enclosure is made of stainless steel 316L through die-casting process, and the transparent lampshade is made of high-strength UV resistant polycarbonate. It is not only suitable for explosive environment, but also suitable for highly corrosive petrochemical, chemical places and marine environment.

The explosion-proof (emergency) LED tubular light fittings adopts modular design, with built-in LED light source module or emergency light source module. Non-emergency explosion-proof tubular light can be equipped with LED tube. Open the lamp cover and pull out the light source module to replace the light source and electrical components, which is convenient for maintenance and replacement.

The explosion-proof (emergency) LED tubular lamps are divided into two mounting types: surface mounting and clamp pipe mounting.

- It is long life and maintenance-free which the service life is up to 50000 hours .
- There is a feature of good electromagnetic compatibility and it does not cause interference to the system power grid.
- It is not influenced by the voltage fluctuations and can be operated in the wide voltage range.
- There is a good performance of vibration due to the LED is the solid-state light source.
- It is convenient to be mounted and maintained.
- The degree of protection is up to IP66 / IP67.
- International IECEx Approval, Europe union ATEX Approval.
- Light efficiency ≥ 135lm/w (Meet China's first-class energy efficiency standards)

1 区和 2 区

21 区和 22 区

Zone 1 and zone 2

Zone 21 and zone 22

示意图 Diagram

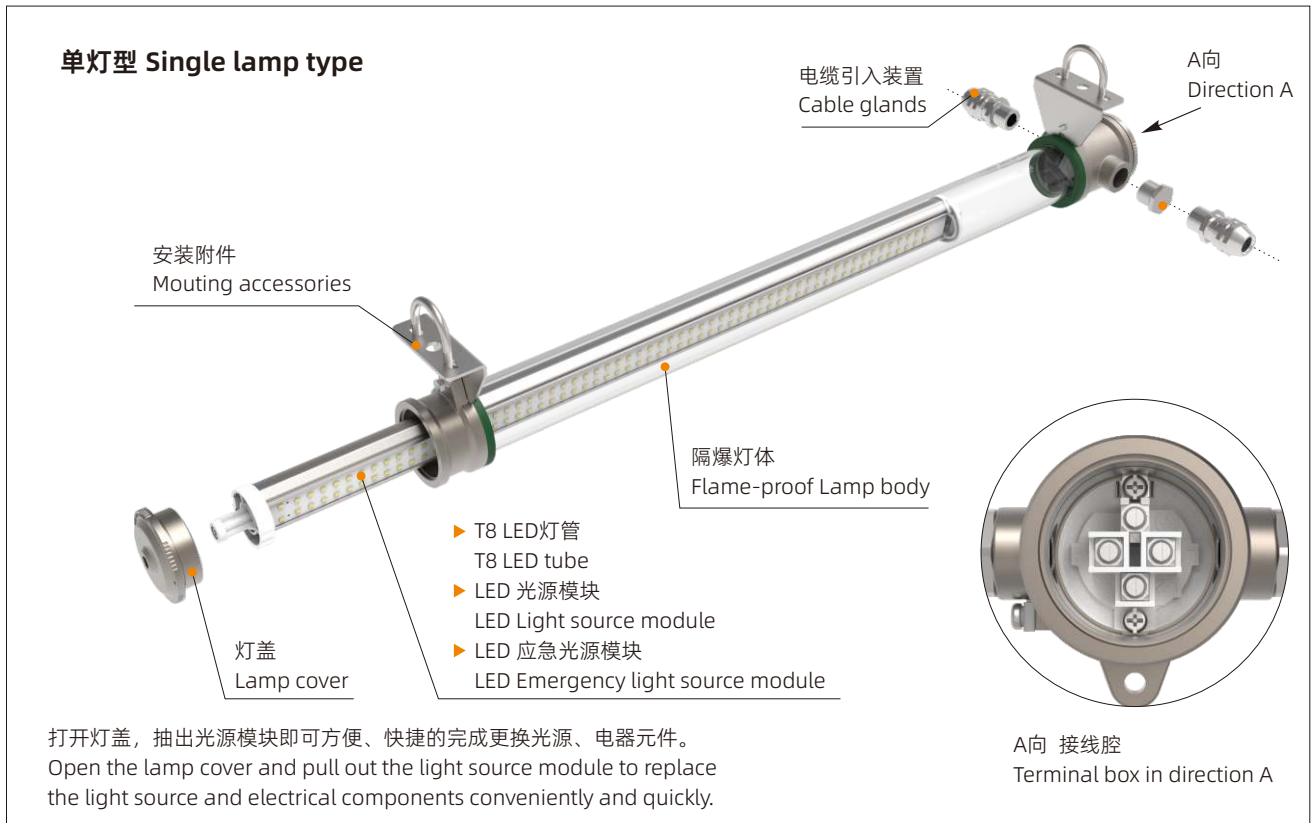

A

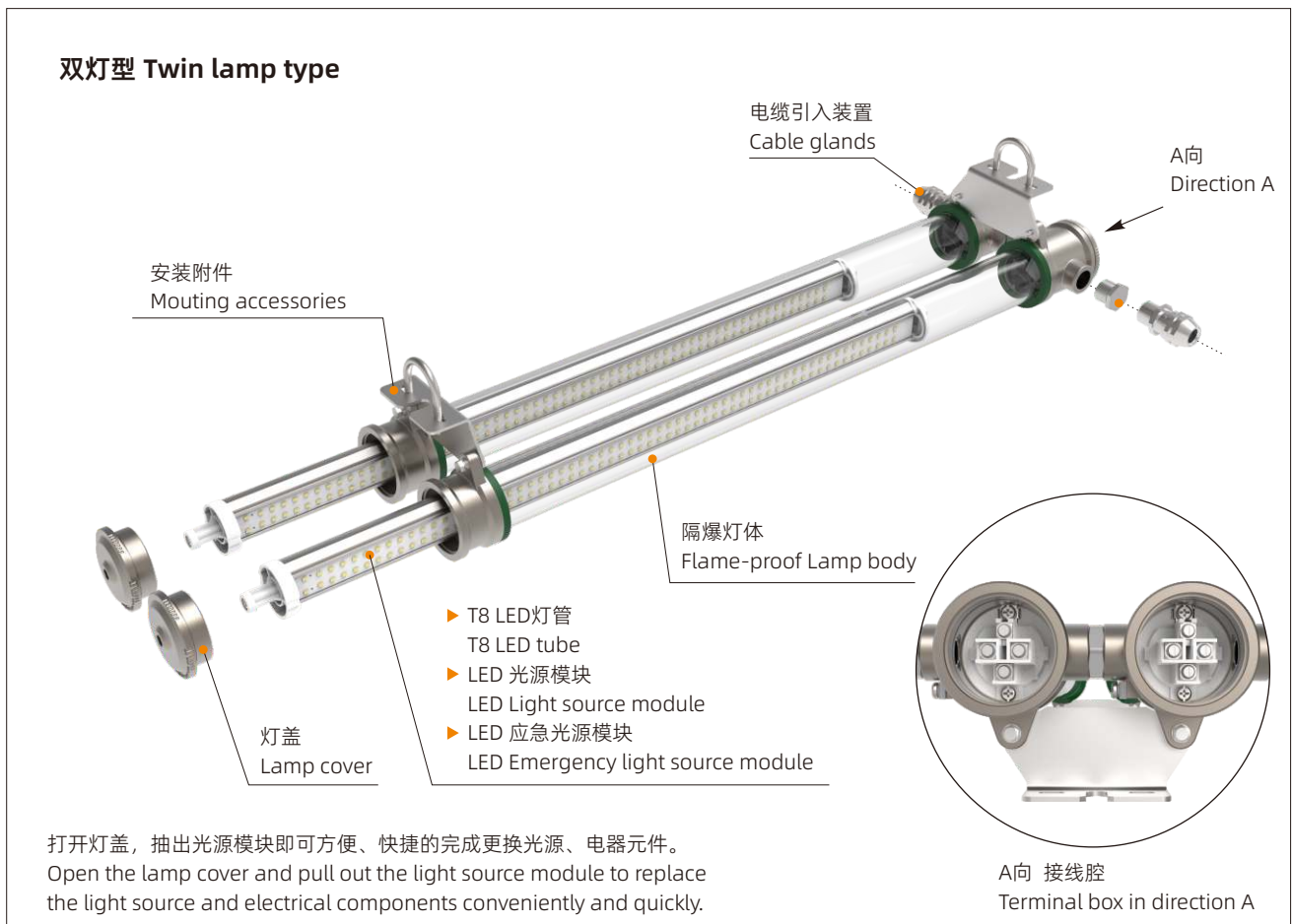

安装线路图 Wiring diagram

A

CZ6365 防爆应急LED管形灯
CZ6365 Explosion-proof emergency
LED tubular light fittings

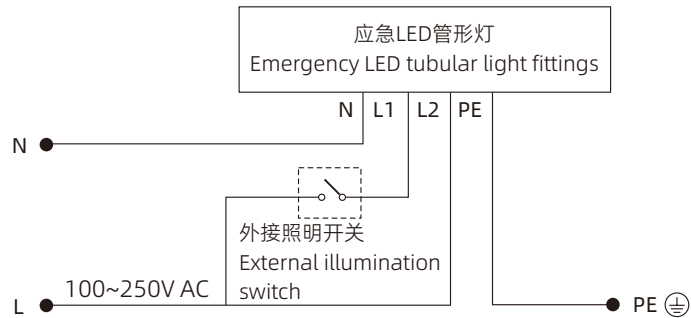

CZ6365 防爆LED管形灯
CZ6365 Explosion-proof
LED tubular light fittings

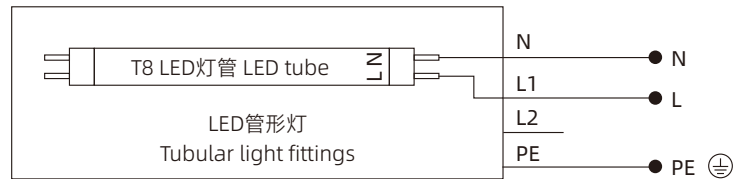

注: 仅选用单端进线的T8 LED灯管
Note: only available for single-ended T8 LED tube

配光曲线 Luminous intensity distribution curve — C0/180 — C90/270

光强单位 luminous intensity unit: cd

防爆LED管形灯 (T8 LED灯管) Explosion-proof LED tubular light fittings (T8 LED tube)

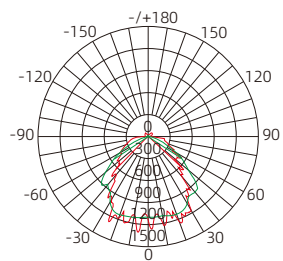

平均光束角 (50%) : 101.1度
The average beam angle (50%) : 101.1 Degree
CZ6365/112 -T8LED0008W□-□

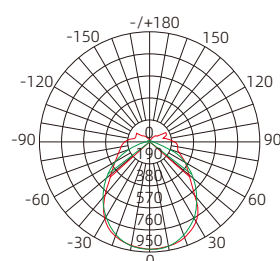

平均光束角 (50%) : 99.8度
The average beam angle (50%) : 99.8 Degree
CZ6365/112 -T8LED2008W□-□

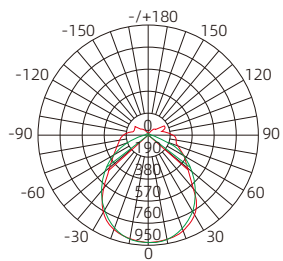

平均光束角 (50%) : 99.8度
The average beam angle (50%) : 99.8 Degree
CZ6365/114 -T8LED0018W□-□

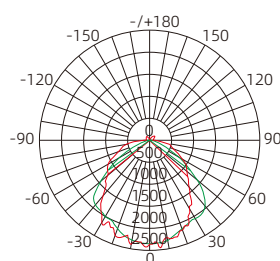

平均光束角 (50%) : 101.2度
The average beam angle (50%) : 101.2 Degree
CZ6365/114 -T8LED2018W□-□

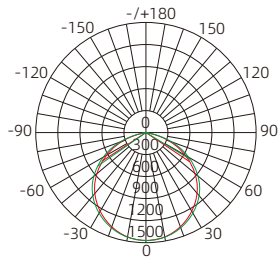
防爆LED管形灯 (LED光源模块) Explosion-proof LED tubular light fittings (LED light source module)

平均光束角 (50%) : 113.5度
 The average beam angle (50%) : 113.5 Degree
CZ6365/112-LED0030W5-17

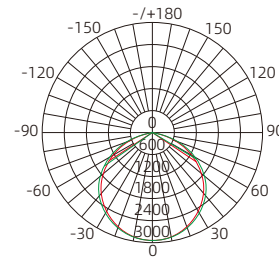

平均光束角 (50%) : 113.5度
 The average beam angle (50%) : 113.5 Degree
CZ6365/112-LED2030W5-17

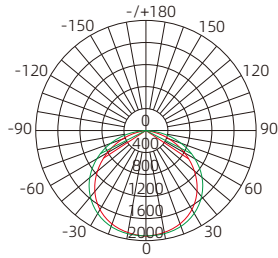

平均光束角 (50%) : 113.9度
 The average beam angle (50%) : 113.9 Degree
CZ6365/113-LED0040W5-17

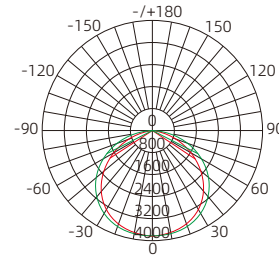

平均光束角 (50%) : 113.9度
 The average beam angle (50%) : 113.9 Degree
CZ6365/113-LED2040W5-17

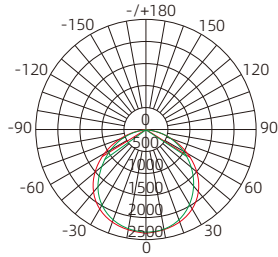

平均光束角 (50%) : 115.9度
 The average beam angle (50%) : 115.9 Degree
CZ6365/114-LED0050W5-17

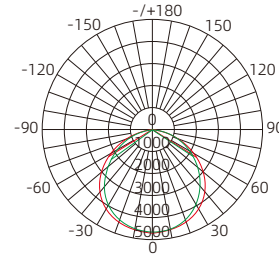

平均光束角 (50%) : 115.9度
 The average beam angle (50%) : 115.9 Degree
CZ6365/114-LED2050W5-17

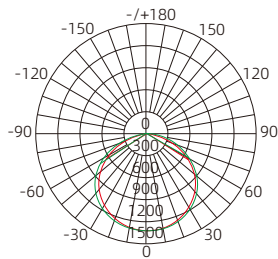
防爆应急LED管形灯 Explosion-proof emergency LED tubular light fittings

平均光束角 (50%) : 115.9度
 The average beam angle (50%) : 115.9 Degree
CZ6365/113-LED0030W5-17-M

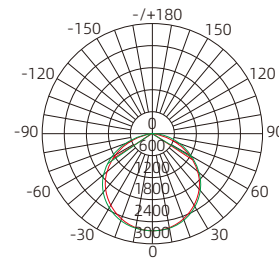

平均光束角 (50%) : 115.9度
 The average beam angle (50%) : 115.9 Degree
CZ6365/113-LED2030W5-17-M

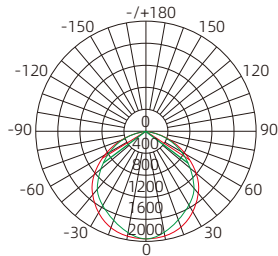

平均光束角 (50%) : 116.9度
 The average beam angle (50%) : 116.9 Degree
CZ6365/114-LED0040W5-17-M

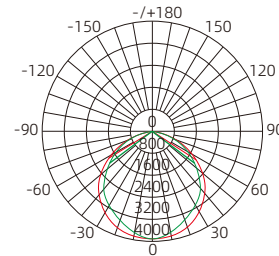

平均光束角 (50%) : 116.9度
 The average beam angle (50%) : 116.9 Degree
CZ6365/114-LED2040W5-17-M

主要数据 Main technical data

认证 Certification	防爆标志 Ex mark	符合标准 Meet the standard
China	Ex db IIB+H ₂ T6 Gb Ex tb IIIC T80°C Db	GB/T3836
IECEX	Ex db IIB+H ₂ T6 Gb Ex tb IIIC T80°C Db	IEC60079
ATEX	Ex II 2GD Ex db IIB+H ₂ T6 Gb Ex tb IIIC T80°C Db	EN60079

适用范围：用于 1 区和 2 区

用于 21 区和 22 区

使用环境温度：-40°C≤Ta≤+55°C

-60°C≤Ta≤+55°C

(-60°C灯具电气设备需要定制)

防护等级：IP66/IP67

额定电压：100~250V AC 50/60Hz, 127~250V DC

光源：LED

色温：标配5000K, (选配3000K、4000K、6500K)

功率因数：λ>0.95

额定功率：

产品型号	CZ6365/112	CZ6365/113	CZ6365/114
T8 LED 灯管	1×8W	/	1×18W
	2×8W		2×18W
LED 模块	1×30W	1×40W	1×50W
	2×30W	2×40W	2×50W

 接线端子：L、N 端子 2.5mm², PE 端子 2×10mm²

电缆入口：1-M20×1.5, 电缆外径：Φ8-12mm (CZ1725/1A)

1-M20×1.5, 空塞堵头 (CZ1725/3A)

外壳材料：316L 不锈钢

PC 聚碳酸酯 (透明灯罩)

Intended use: Can be used in zone 1 and zone 2

Can be used in zone 21 and zone 22

Ambient temperature use: -40°C≤Ta≤+55°C

-60°C≤Ta≤+55°C

(-60°C lamp need to be customized)

Degree of protection: IP66/IP67

Rated voltage: 100~250V AC 50/60Hz, 127~250V DC

Light source: LED

Colour temperature: Standard 5000K, (Optional 3000K, 4000K, 6500K)

Power factor: λ>0.95

Rated power:

Type	CZ6365/112	CZ6365/113	CZ6365/114
T8 LED Tube	1×8W	/	1×18W
	2×8W		2×18W
LED Module	1×30W	1×40W	1×50W
	2×30W	2×40W	2×50W

 Terminals: L, N terminal 2.5mm², PE terminal 2×10mm²

Cable entry: 1-M20×1.5, outside diameter of cable: Φ8-12mm (CZ1725/1A)

1-M20×1.5, stopping plugs (CZ1725/3A)

Material of enclosure: 316L stainless steel

PC Polycarbonate (transparent lampshade)

订购规格 Order specifications

图样 Illustration	功率 Power	光源代号 Light source code	光通量 Luminous flux	重量 Weight (kg)	订购号 Order No.
	1×LED 8W	T8 LED 灯管 Tube	/	2.3	CZ6365/112-T8LED0008W6-17-□-D11
	1×LED 18W	T8 LED 灯管 Tube	/	3.0	CZ6365/114-T8LED0018W6-17-□-D11
	1×LED 30W	LED 模块 Module	4142 lm	2.6	CZ6365/112-LED0030W5-17-□-D11
	1×LED 40W	LED 模块 Module	5502 lm	2.8	CZ6365/113-LED0040W5-17-□-D11
	1×LED 50W	LED 模块 Module	6784 lm	3.2	CZ6365/114-LED0050W5-17-□-D11
	2×LED 8W	T8 LED 灯管 Tube	/	4.3	CZ6365/112-T8LED2008W6-17-□-D11
	2×LED 18W	T8 LED 灯管 Tube	/	5.8	CZ6365/114-T8LED2018W6-17-□-D11
	2×LED 30W	LED 模块 Module	8284 lm	4.7	CZ6365/112-LED2030W5-17-□-D11
	2×LED 40W	LED 模块 Module	11004 lm	5.3	CZ6365/113-LED2040W5-17-□-D11
	2×LED 50W	LED 模块 Module	13568 lm	6.0	CZ6365/114-LED2050W5-17-□-D11

3-3000K 5-5000K } ← 色温 (不配不注)
 4-4000K 6-6500K } ← Colour temperature (Optional)

4- -40°C≤Ta≤+55°C } ← 使用环境温度
 6- -60°C≤Ta≤+55°C } ← Ambient temperature

电缆引入装置编码 Code of cable gland ←

注：T8 LED灯管出厂不配，见 A/08 页；T8 LED灯管安装在灯具内，光通量约损耗15%。

Note: T8 LED tube be ordered separately by users, see page A/08, The luminous flux loss around 15% when T8 LED tube is installed in the lamp.

主要数据 Main technical data

认证 Certification	防爆标志 Ex mark	符合标准 Meet the standard
China	Ex db IIB+H ₂ T6 Gb Ex tb IIIC T80°C Db	GB/T3836
IECEX	Ex db IIB+H ₂ T6 Gb Ex tb IIIC T80°C Db	IEC60079
ATEX	Ex II 2GD Ex db IIB+H ₂ T6 Gb Ex tb IIIC T80°C Db	EN60079

适用范围：用于 1 区和 2 区

用于 21 区和 22 区

使用环境温度：-40°C≤Ta≤+50°C

防护等级：IP66/IP67

额定电压：100 ~ 250V AC 50/60Hz, 127~250V DC

光源：LED

色温：标配5000K, (选配3000K、4000K、6500K)

功率因数：λ > 0.95

充电时间：24 h

电池充电环境温度：0°C ~ +45°C

电池放电环境温度：-20°C ~ +60°C

应急启动时间：0.1s

应急照明时间：> 180min

额定功率：

产品型号	CZ6365/113	CZ6365/114
LED 模块	1×30W	1×40W
	2×30W	2×40W

接线端子：L1、L2、N 端子 2.5mm², PE 端子 2×10mm²

电缆入口：1-M20×1.5, 电缆外径：Φ8-12mm (CZ1725/1A)
1-M20×1.5, 空塞堵头 (CZ1725/3A)

外壳材料：316L 不锈钢

PC 聚碳酸酯 (透明灯罩)

Intended use: Can be used in zone 1 and zone 2

Can be used in zone 21 and zone 22

Ambient temperature use: -40°C≤Ta≤+50°C

Degree of protection: IP66/IP67

Rated voltage: 100 ~ 250V AC 50/60Hz, 127~250V DC

Light source: LED

Colour temperature: Standard 5000K, (Optional 3000K, 4000K, 6500K)

Power factor: λ > 0.95

Recharging time: 24 h

Battery charging ambient temperature: 0°C ~ +45°C

Battery discharge ambient temperature: -20°C ~ +60°C

Emergency starting time: 0.1s

Emergency illuminating time: > 180 min

Rated power:

Type	CZ6365/113	CZ6365/114
LED Module	1×30W	1×40W
	2×30W	2×40W

Terminals: L1, L2, N terminal 2.5mm², PE terminal 2×10mm²

Cable entry: 1-M20×1.5, outside diameter of cable: Φ8-12mm (CZ1725/1A)
1-M20×1.5, stopping plugs (CZ1725/3A)

Material of enclosure: 316L stainless steel

PC Polycarbonate (transparent lampshade)



订购规格 Order specifications

图样 Illustration	功率 Power		光通量 Luminous flux		重量 Weight (kg)	订购号 Order No.
	正常照明 Normal illumination	应急照明 Emergency illumination	正常照明 Normal illumination	应急照明 Emergency illumination		
	1×LED 30W	1×LED 8W	3822 lm	1000 lm	3.2	CZ6365/113-LED0030W5-17-M-4-D11
	1×LED 40W	1×LED 8W	5679 lm	1000 lm	3.6	CZ6365/114-LED0040W5-17-M-4-D11
	2×LED 30W	2×LED 8W	7644 lm	2000 lm	6.1	CZ6365/113-LED2030W5-17-M-4-D11
	2×LED 40W	2×LED 8W	11358 lm	2000 lm	6.8	CZ6365/114-LED2040W5-17-M-4-D11

3-3000K 5-5000K } ← 色温
4-4000K 6-6500K } ← Colour temperature

M-持续性 Maintained ← 应急型式
Type of emergency

4- -40°C≤Ta≤+50°C ← 使用环境温度
Ambient temperature

电缆引入装置编码 Code of cable gland ←

电缆引入装置编码 Code of cable gland

编码 Code	规格 Specifications	电缆直径 Cable diameter
D11	316L不锈钢 1个 CZ1725/1A M20×1.5 电缆密封套, 316L不锈钢 1个 CZ1725/3A M20×1.5 空塞堵头 One 316L stainless steel CZ1725/1A M20×1.5 cable gland, one 316L stainless steel M20×1.5 stopping plug	Φ8-12mm
D12	316L不锈钢 2个 CZ1725/1A M20×1.5 电缆密封套 Two 316L stainless steel CZ1725/1A M20×1.5 cable glands	Φ8-12mm

A
安装形式和外形尺寸 Mounting way and outline dimension

单位 Unit: mm

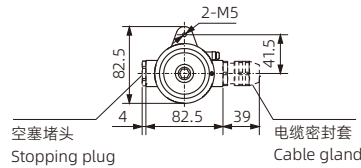
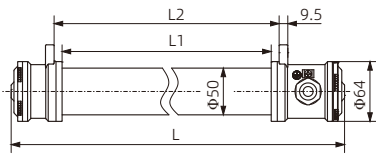

型号 Type	L	L1	L2	L3
CZ6365/112	712	579	596	627
CZ6365/113	1017	884	901	932
CZ6365/114	1322	1189	1206	1237

隔爆型 (应急) LED管形灯

Flameproof (emergency) tubular light fittings

平面式安装

Surface mounting type

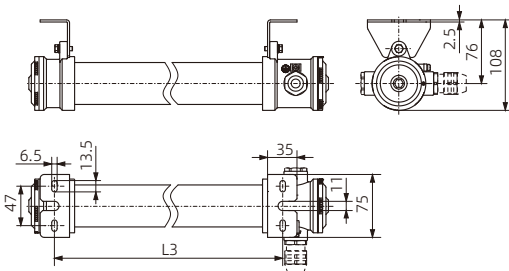
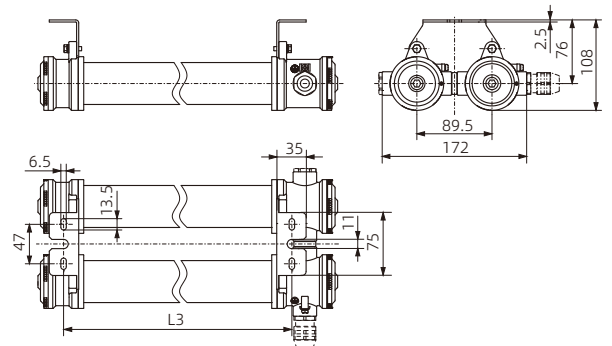

 单灯
Single Lamp

 双灯
Twin Lamp

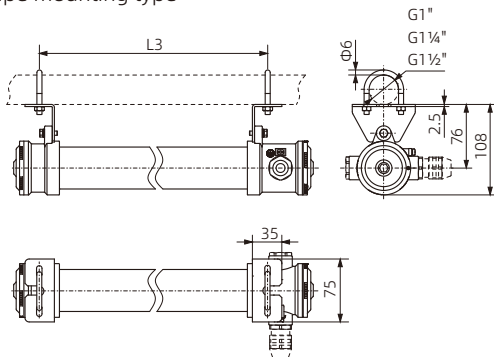
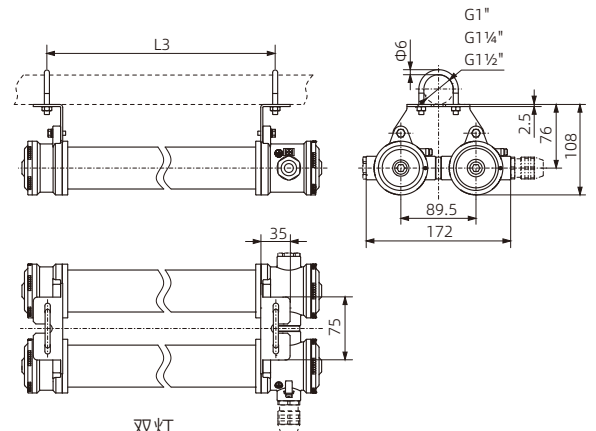
夹管式安装

Clamp pipe mounting type

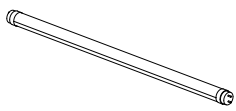
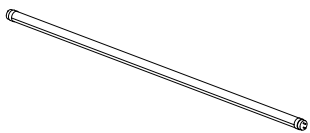
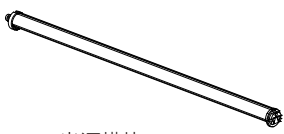
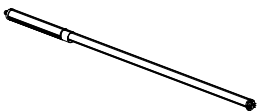
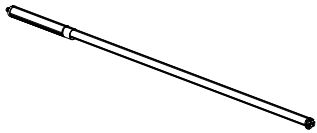
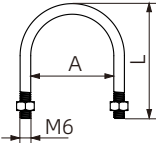
 单灯
Single Lamp

 双灯
Twin Lamp

备件 Spare parts

图样 Illustration	描述 Descriptions	单位 Unit	订购号 Order No.			
 “PHILIPS飞利浦” T8 LED灯管 “PHILIPS” T8 LED tubes	T8 8W LED灯管, 电压220~240V AC 50~60Hz, 光通量800Lm, 色温6500K, 寿命40000h T8 8W LED tube, Voltage 220~240V AC 50~60Hz, Luminous flux 800 Lm, Color temperature 6500K, Lifetime 40000 hours	只 Piece	600mm 8W 865 HO 800lm			
 “PHILIPS飞利浦” T8 LED灯管 “PHILIPS” T8 LED tubes	T8 18W LED灯管, 电压220~240V AC 50~60Hz, 光通量2100Lm, 色温6500K, 寿命40000h T8 18W LED tube, Voltage 220~240V AC 50~60Hz, Luminous flux 2100 Lm, Color temperature 6500K, Lifetime 40000 hours	只 Piece	1200mm 18W 865 HO 2100lm			
 30W LED 光源模块 30W LED Light source module	电压100~250V AC 50/60Hz, 127~250V DC, 光通量5400 Lm, 色温5000K, 寿命50000h Voltage 100~250V AC 50/60Hz, 127~250V DC, Luminous flux 5400 Lm, Color temperature 5000K, Lifetime 50000 hours	只 Piece	CZ6365-12-LED30W5			
 40W LED 光源模块 40W LED Light source module	电压100~250V AC 50/60Hz, 127~250V DC, 光通量7200 Lm, 色温5000K, 寿命50000h Voltage 100~250V AC 50/60Hz, 127~250V DC, Luminous flux 7200 Lm, Color temperature 5000K, Lifetime 50000 hours	只 Piece	CZ6365-13-LED40W5			
 50W LED 光源模块 50W LED Light source module	电压100~250V AC 50/60Hz, 127~250V DC, 光通量8900 Lm, 色温5000K, 寿命50000h Voltage 100~250V AC 50/60Hz, 127~250V DC, Luminous flux 8900 Lm, Color temperature 5000K, Lifetime 50000 hours	只 Piece	CZ6365-14-LED50W5			
 30W LED应急光源模块 30W LED emergency Light source module	电压100~250V AC 50/60Hz, 127~250V Dc, 正常照明功率/光通量 30W/5000 Lm 应急照明功率/光通量 8W/1200 Lm 色温5000K, 寿命50000h Voltage 100~250V AC 50/60Hz,127~250V DC, Normal illumination power/luminous flux 30W/5000 Lm Emergency illumination power/luminous flux 8W/1200 Lm Color temperature 5000K, Lifetime 50000 hours	只 Piece	CZ6365-13-LED30W5-M			
 40W LED应急光源模块 40W LED emergency Light source module	电压100~250V AC 50/60Hz, 127~250V Dc, 正常照明功率/光通量 40W/7400 Lm 应急照明功率/光通量 8W/1360 Lm 色温5000K, 寿命50000h Voltage 100~250V AC 50/60Hz,127~250V DC, Normal illumination power/luminous flux 40W/7400 Lm Emergency illumination power/luminous flux 8W/1360 Lm Color temperature 5000K, Lifetime 50000 hours	只 Piece	CZ6365-14-LED40W5-M			
 316不锈钢 U型螺栓 U type accessories stainless steel 316	规格 Specifications	A	L	钢管尺寸 Steel pipe size	只 Piece	U633
	M6×33	41mm	53mm	Φ33mm or G1		
	M6×42	50mm	62mm	Φ42mm or G1 ¼		
	M6×48	56mm	68mm	Φ48mm or G1 ½		

A